

SC SafeLock Adaptor - Simplex/Duplex

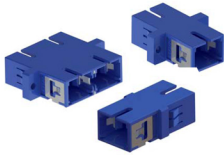

OPTiFab presents innovative "SAFE LOCK" SC simplex and duplex adaptors for advanced data center and FTTX applications. The unique adaptor lock mechanism is designed for preventing accidental fibre disconnection of important channel links.

The adaptor housing is moulded in one piece, giving enhanced precision, structure, and reliable performance. Used with any STANDARD SC patchcord.

PARAMETER	SPECIFICATION
Maximum insertion loss (dB)	S.M. ≤ 0.2dB; M.M. ≤ 0.3dB; APC. ≤ 0.2dB
Mating durability	<0.2dB typical variation, 200 mating
Operating Temperature	-20 ~ +75 °C
Storage Temperature	-40 ~ +85 °C
Humidity (NON-Condensing)	95% R.H.

TECHNICAL PARAMETER

- Patented SC SAFE LOCK adaptor. (2.0kgf minimum release force)
- Unlock tool available for high density application.
- Enhanced housing and clip moulded in one piece.
- Excellent mechanical properties giving stable repeat IL.
- Innovative mounting clip design.
- Compatible with SC adaptor internal shutter clip.
- Compliant with RoHS/REACH and UL 94-V0.

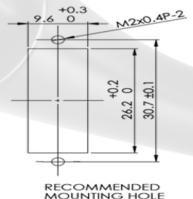
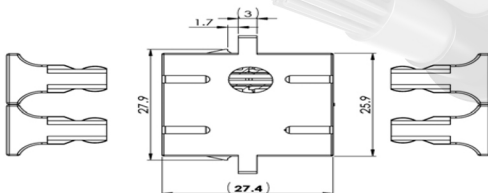
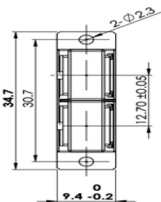
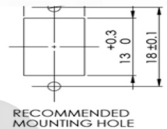
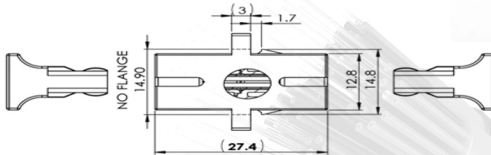
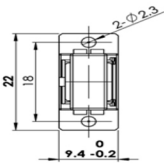

LC SafeLock Adaptor - Duplex

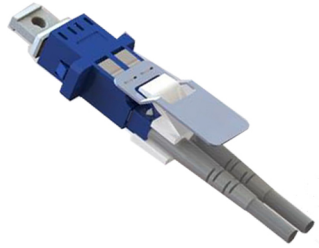

FEATURES

- PLC Adaptor Complies With IEC 61754-20 Industrial Standard
- All Material Compliant With Rohs
- Housing Material: PEI
- Alignment Sleeve: Zro2(S.M.) / Phbr(M.M.)
- Insertion Loss: 0.2Db Max.(Zro2) / 0.3Db Max.(Phbr)
- Retention Force: 100~250 Gm(Zro2) / 100~300 Gm(Phbr)
- Durability (200 Mating): 0.2Db Max. Increase.
- Operating Temperature: -20~+75 °C
- Storage Temperature: -40~+85 °C
- Humidity (Non-Condensing): 95% Rh
- Mounting Panel Thickness: 1.7mm Max

